

Fire Evacuation Key

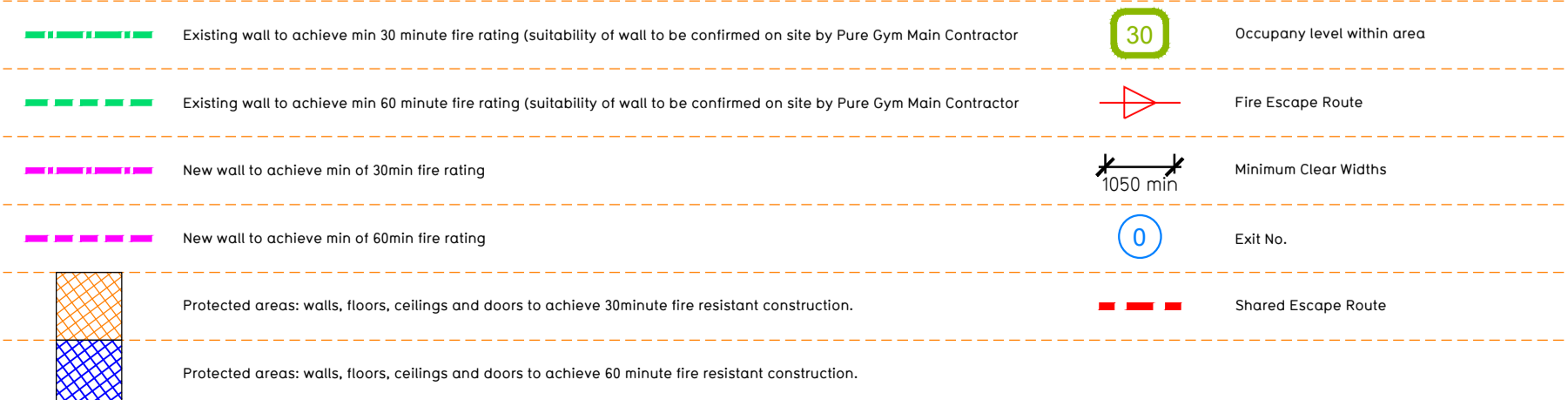

2064 - Northalerton Calculation

Escape Route Widths:
In line with Sections 3.21 & 3.22 of Approved Document Part B, Volume 2 - buildings other than dwellinghouses - the adjacent calculations provide justification for the clear opening widths for escape from each floor level/ room in accordance with Table 4 & Appendix C.

Ground Floor
Final Exit 1 Clear Opening Width = 1230mm (allows 263 persons to escape)
Final Exit 3 Clear Opening Width = 1050mm (allows 220 persons to escape)
(largest opening to be discounted)
Total Aggregate Width for Floor (Less Largest Opening Width of 1230mm from FINAL EXIT 1) = 1213mm

Mezzanine Floor
Final Exit 4 Fed by Storey Exit A, Clear Opening Width = 1050mm (allows 220 persons to escape)
Final Exit 2 Fed by Storey Exit B, Clear Opening Width = 1050mm (allows 220 persons to escape)
(largest opening to be discounted)
Total Aggregate Width for Floor (Less Largest Opening Width of 1050mm from STOREY EXIT A) = 1050mm

Total
Ground Floor = 270 persons to escape
Mezzanine Floor = 230 persons to escape
Total = 440 persons to escape

Based on a NIA of 833sqm, the Puregym peak Occupancy Target = 105 Persons
Calculated using Puregym Fire Safety Occupancy Levels Forecast Tool

The designed occupancy of the unit as calculated would allow a max. No. of 440 persons to escape, which is larger than the total estimated occupancy capacity of 105 persons and is therefore thought to meet with the Approved Document Part B. To allow free movement between the floors the occupancy has not been split 50/50% but rather allows for occupancy based on gym stations and functions assuming that a high percentage of the total occupancy could be on a single floor at one time.

Fire Alarm
Fire Alarm designed and installed to BS 5839. Smoke & heat detection / emergency lighting by specialist. Please refer to M&E engineer's drawings / specifications.

Escape Lighting
Emergency escape lighting designed and installed in accordance with BS 5266: Part 1. Please refer to M&E Engineer's drawings for final layout and specification.
Escape Signage and emergency lighting is CDP under the MSE specification. Details of contractors proposals to be provided to Building Control Approved Inspector and Fire Officer within the Contractors Proposals Package, Clause 14

CD1 103.05.2022 Drawing amended to reflect General Arrangement Plan revision C02					
	Rev	Date	Description	IR/FG	Drawn/Checked
		PROJECT TITLE		DRAWING TITLE	
Northalerton Unit B, Yafforth Road Retail Park, DL6 2XG				Means Of Escape Plan Ground and Mezzanine Floor Plans	
DRAWN / CHECKED	DATE	SCALE	JOB No.	DRAWING No.	Rev
MJI/IR	28.06.21	1:100 @ A1	2064	003-FEP	001
CONSTRUCTION					
		Pure Gym Ltd Town Centre House The Merrion Centre Leeds LS2 9LY e: architecture@puregym.com t: 0113 285 8787 w: www.puregym.com			